



Your Family Architect



For Questions and Ordering

Call: 1-888-272-4100

E-mail: Info@ArchitectsNW.com

TREEMONT LANE - M4060B3F-8R

Total Area: **4599 Sq. Ft.**
Garage Area: **922 Sq. Ft.**
Garage Size: **3**
Stories: **2**
Bedrooms : **5**
Full Baths : **4**
Half Baths : **1**
Width : **66`-3"**
Depth : **79`-6"**
Height : **32`-1"**
Foundation : **Crawl Space**



TREEMONT LANE - M4060B3F-8R

MAIN FLOOR



TREEMONT LANE - M4060B3F-8R

UPPER FLOOR

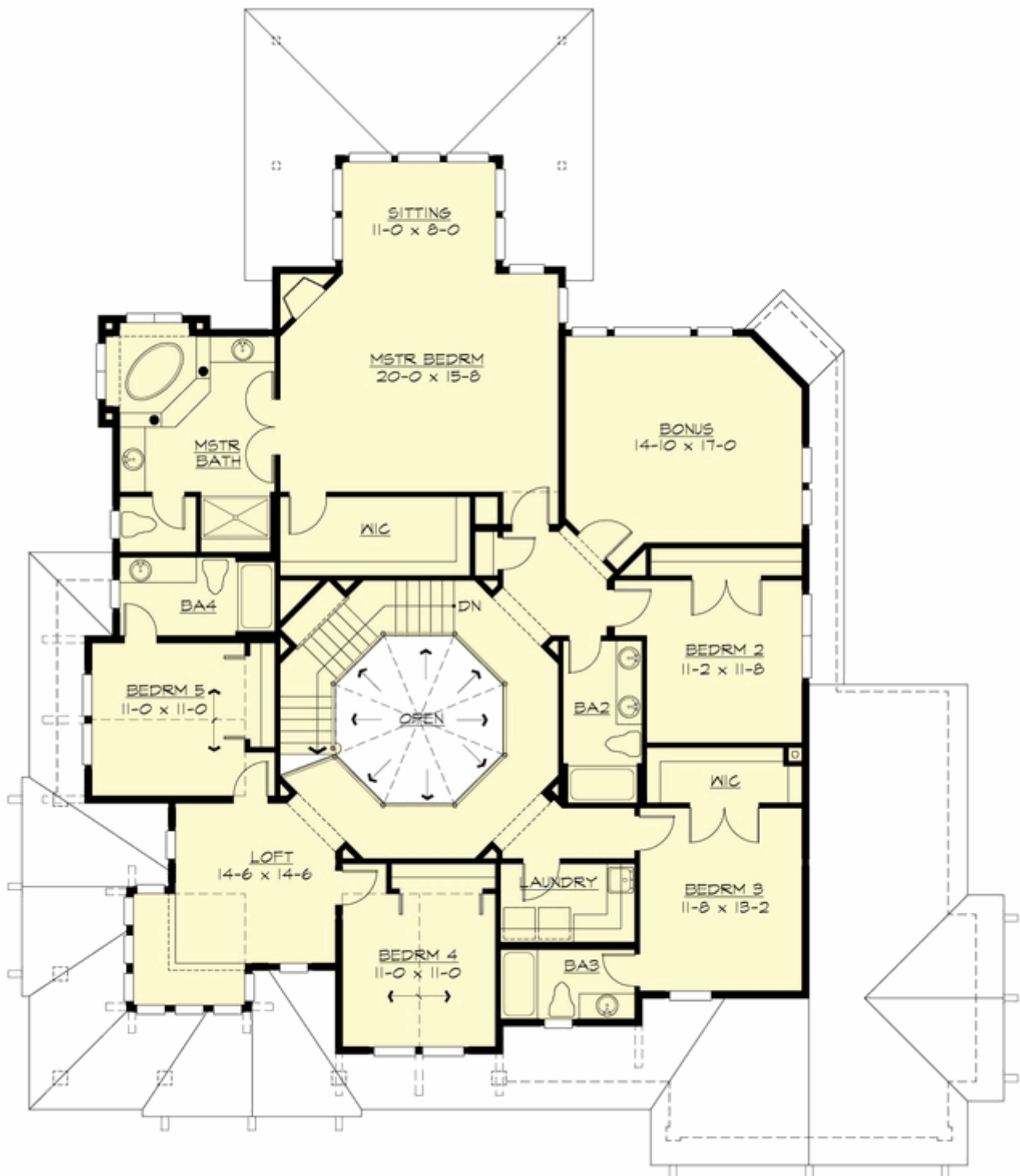

TREEMONT LANE - M4060B3F-8R

PLAN DETAILS

Area Summary

Total Area:	4599 Sq. Ft.
Main Floor:	2139 Sq. Ft.
Upper Floor:	2460 Sq. Ft.
Garage Floor:	922 Sq. Ft.

General Information

Stories:	2
Width:	66`-3"
Depth:	79`-6"
Height:	32`-1"

Architectural Style

Craftsman
Lodge
Northwest

Number of Rooms

Bedrooms:	5
Full Baths:	4
Half Baths:	1

Garage

Garage Size:	3
Garage Door Location:	Front

Roof Pitches

Primary:	6:12
Secondary:	4:12

Wall Heights

Main:	10-0"
Upper:	9-0"

Foundation Type

Crawl Space

Roof Framing

Trusses

Floor Load

Live (lbs):	40 PSF
Dead (lbs):	10 PSF

Roof Load

Live (lbs):	25 PSF
Dead (lbs):	15 PSF
Wind:	85 MPH

Design Features

- Bonus Space @ & Upper Floor
- Den/Office
- Front and Rear Porch
- Great Room
- Laundry Room @ & Upper Floor
- Master Bedroom @ Upper Floor Rear
- Craftsman House Plans
- Lodge House Plans
- Northwest Floor Plans
- View Lot (Rear) Plans
- Wide Lot House Plans