



For Questions and Ordering

Call: 1-888-272-4100

E-mail: Info@ArchitectsNW.com

MANSVILLE GROVE - R5340A4FAT-1

Total Area: **5428 Sq. Ft.**
Garage Area: **1807 Sq. Ft.**
Garage Size: **4**
Stories: **2**
Bedrooms : **3**
Full Baths : **4**
Half Baths : **1**
Width : **130`-0"**
Depth : **109`-6"**
Height : **27`-6"**
Foundation : **Crawl Space**



MANSVILLE GROVE - R5340A4FAT-1

MAIN FLOOR



MANSVILLE GROVE - R5340A4FAT-1

UPPER FLOOR

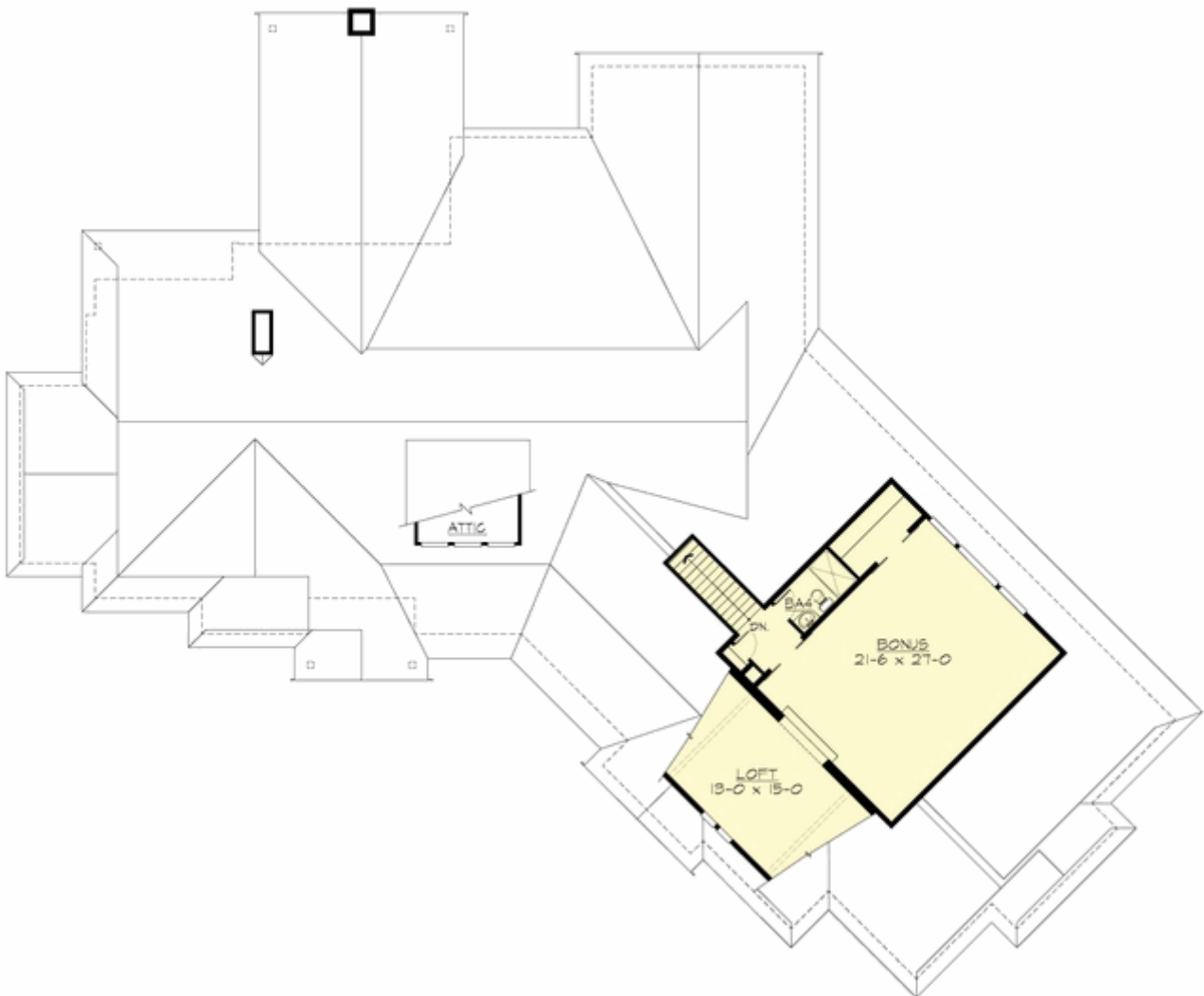

MANSVILLE GROVE - R5340A4FAT-1

PLAN DETAILS

Area Summary

Total Area:	5428 Sq. Ft.
Main Floor:	4423 Sq. Ft.
Upper Floor:	1005 Sq. Ft.
Garage Floor:	1807 Sq. Ft.

General Information

Stories:	2
Width:	130`-0"
Depth:	109`-6"
Height:	27`-6"

Architectural Style

Craftsman
Shingle
Traditional

Number of Rooms

Bedrooms:	3
Full Baths:	4
Half Baths:	1

Garage

Garage Size:	4
Garage Door Location:	Front
Garage Type:	Angled

Roof Pitches

Primary:	10:12
Secondary:	5:12

Wall Heights

Main:	10-0"
Upper:	9-0"

Foundation Type

Crawl Space

Roof Framing

Combination

Floor Load

Live (lbs):	40 PSF
Dead (lbs):	10 PSF

Roof Load

Live (lbs):	25 PSF
Dead (lbs):	15 PSF
Wind:	85 MPH

Design Features

- Bonus Space @ Main & Upper Floor
- Den/Office
- Rear Porch
- Great Room
- Laundry Room @ Main Floor
- Master Bedroom @ Main Floor Rear
- Craftsman House Plans
- Shingle House Plans
- Traditional House Plans
- View Lot (Rear) Plans
- Wide Lot House Plans