



Your Family Architect



For Questions and Ordering

**Call: 1-888-272-4100**

E-mail: [Info@ArchitectsNW.com](mailto:Info@ArchitectsNW.com)

## LAKE MOXIE - R2615A3F-0DB

Total Area: **2615 Sq. Ft.**

Garage Area: **735 Sq. Ft.**

Garage Size: **3**

Stories: **2**

Bedrooms : **4**

Full Baths : **3**

Half Baths : **1**

Width : **62'-0"**

Depth : **47'-0"**

Height : **20'-6"**

Foundation : **Basement**



# LAKE MOXIE - R2615A3F-0DB

## MAIN FLOOR



# LAKE MOXIE - R2615A3F-0DB

## LOWER FLOOR

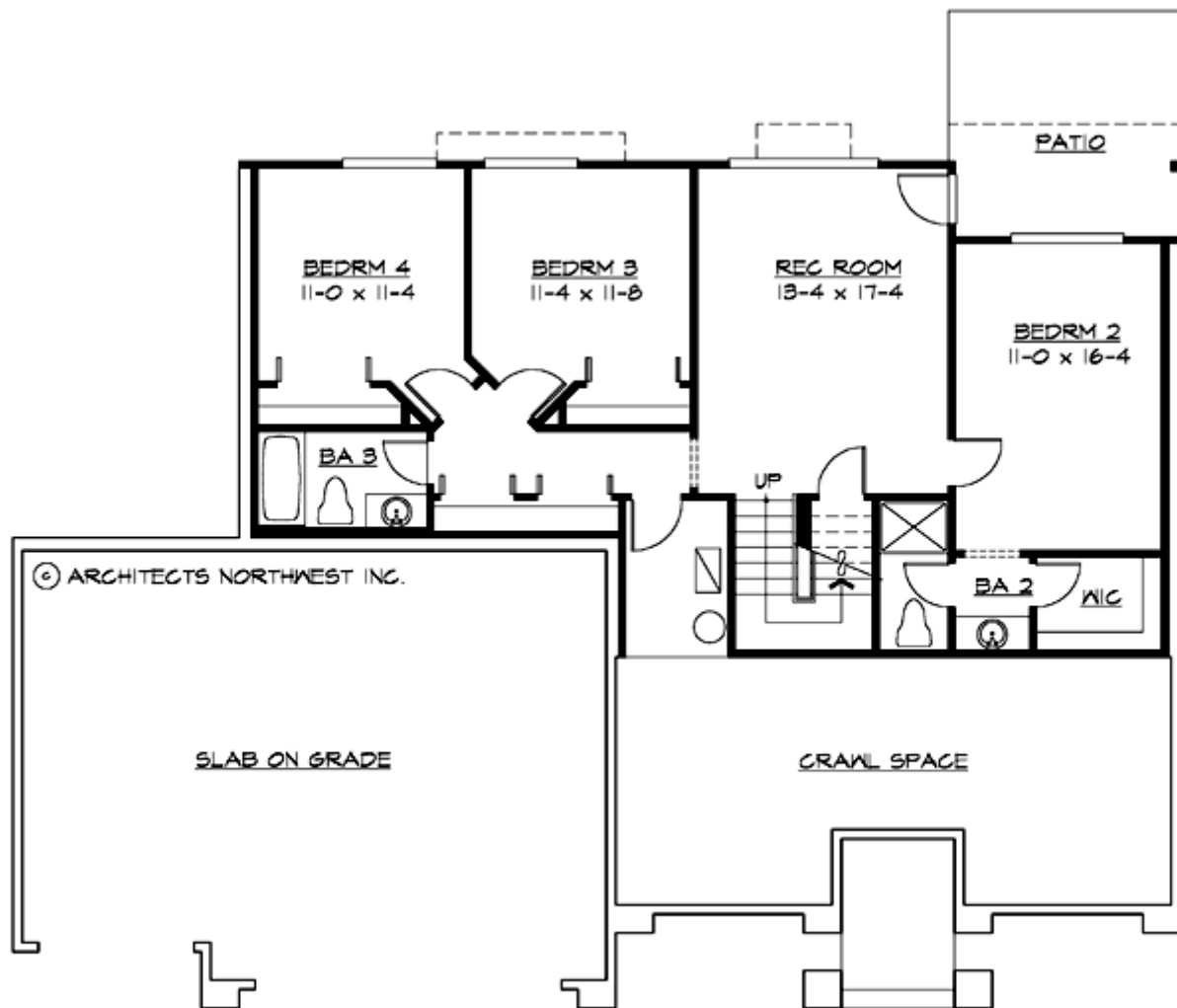

# LAKE MOXIE - R2615A3F-0DB

## PLAN DETAILS

### Area Summary

Total Area:	2615 Sq. Ft.
Main Floor:	1550 Sq. Ft.
Lower Floor:	1065 Sq. Ft.
Garage Floor:	735 Sq. Ft.

### General Information

Stories:	2
Width:	62`-0"
Depth:	47`-0"
Height:	20`-6"

### Architectural Style

Craftsman  
Northwest  
Ranch

### Number of Rooms

Bedrooms:	4
Full Baths:	3
Half Baths:	1

### Garage

Garage Size:	3
Garage Door Location:	Front

### Roof Pitches

Primary:	6:12
Secondary:	8:12

### Wall Heights

Main:	10-0"
Lower:	8-0"

### Foundation Type

Daylight Basement

### Roof Framing

Trusses

### Floor Load

Live (lbs):	40 PSF
Dead (lbs):	10 PSF

### Roof Load

Live (lbs):	25 PSF
Dead (lbs):	15 PSF
Wind:	85 MPH

### Design Features

- Bonus Space @ & Lower Floor
- Great Room
- Laundry Room @ Main Floor
- Master Bedroom @ Main Floor Rear
- Craftsman House Plans
- Northwest Floor Plans
- Ranch House Plans
- View Lot (Rear) Plans