

HICKORY - R1840A3S-0

Total Area: **1840 Sq. Ft.**

Garage Area: **675 Sq. Ft.**

Garage Size: **3**

Stories: **1**

Bedrooms : **3**

Full Baths : **2**

Half Baths :

Width : **54'-0"**

Depth : **68'-0"**

Height : **18'-0"**

Foundation :



HICKORY - R1840A3S-0

MAIN FLOOR

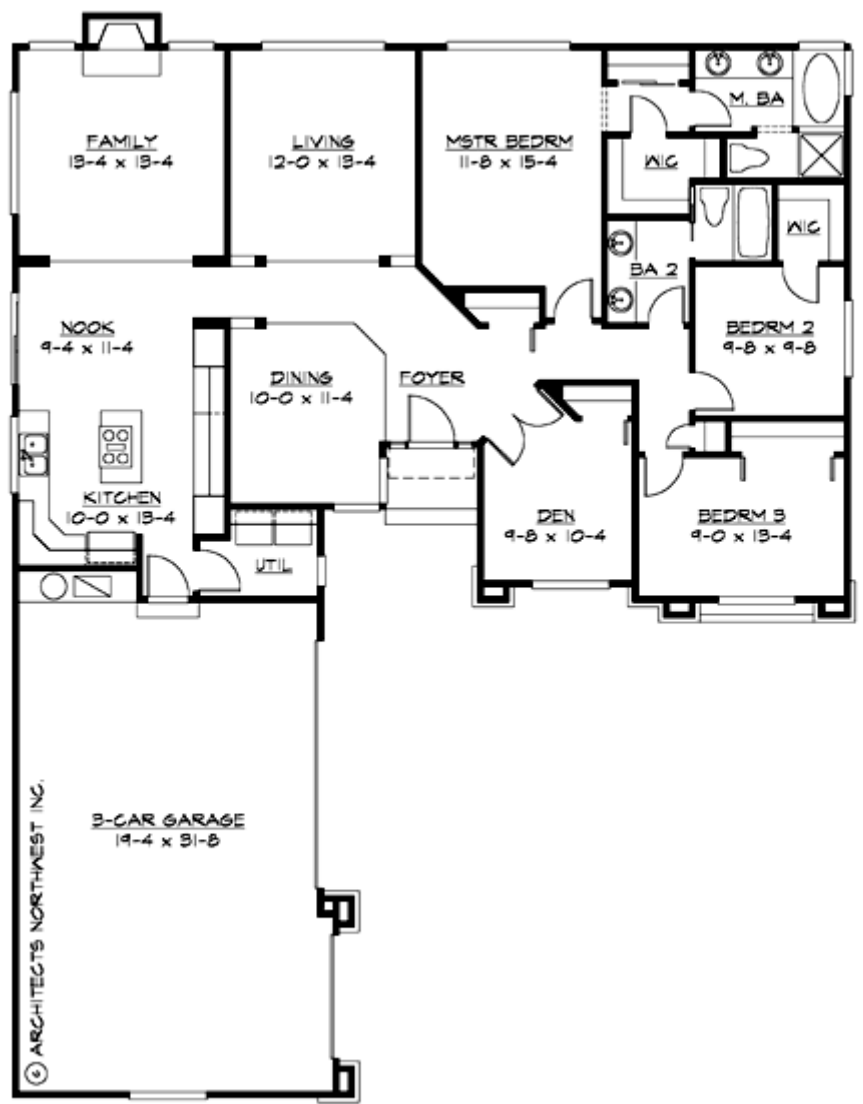

HICKORY - R1840A3S-0

PLAN DETAILS

Area Summary

Total Area:	1840 Sq. Ft.
Main Floor:	1840 Sq. Ft.
Garage Floor:	675 Sq. Ft.

General Information

Stories:	1
Width:	54`-0"
Depth:	68`-0"
Height:	18`-0"

Architectural Style

Craftsman
Northwest
Ranch

Number of Rooms

Bedrooms:	3
Full Baths:	2

Garage

Garage Size:	3
Garage Door Location:	Side

Roof Pitches

Primary:	7:12
----------	------

Wall Heights

Main:	8-0"
-------	------

Foundation Type

Roof Framing

Trusses

Floor Load

Live (lbs):	40 PSF
Dead (lbs):	10 PSF

Roof Load

Live (lbs):	25 PSF
Dead (lbs):	15 PSF
Wind:	85 MPH

Design Features

- Den/Office
- Great Room
- Laundry Room @ Main Floor
- Master Bedroom @ Main Floor Rear
- Craftsman House Plans
- Northwest Floor Plans
- Ranch House Plans
- Small House Plans