



For Questions and Ordering

Call: 1-888-272-4100

E-mail: Info@ArchitectsNW.com

FORTUNE CREEK LODGE - M7800A3FA-0

Total Area: **8450 Sq. Ft.**

Garage Area: **1575 Sq. Ft.**

Garage Size: **3**

Stories: **2**

Bedrooms : **6**

Full Baths : **5**

Half Baths : **2**

Width : **154`-0"**

Depth : **112`-0"**

Height : **33`-0"**

Foundation : **Crawl Space**



FORTUNE CREEK LODGE - M7800A3FA-0

MAIN FLOOR

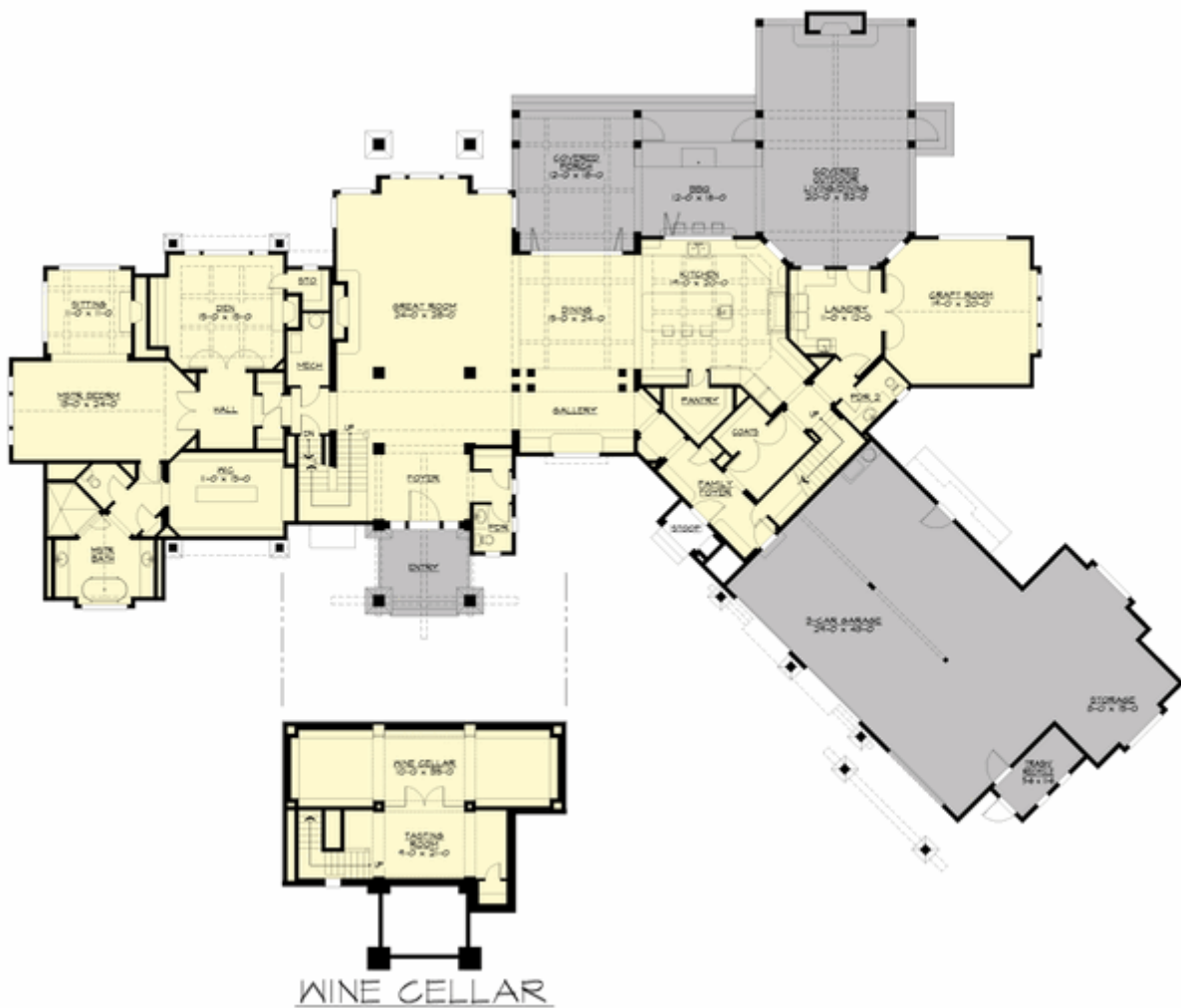

FORTUNE CREEK LODGE - M7800A3FA-0

UPPER FLOOR



FORTUNE CREEK LODGE - M7800A3FA-0

PLAN DETAILS

Area Summary

Total Area:	8450 Sq. Ft.
Main Floor:	4468 Sq. Ft.
Upper Floor:	3332 Sq. Ft.
Lower Floor:	650 Sq. Ft.
Garage Floor:	1575 Sq. Ft.

General Information

Stories:	2
Width:	154`-0"
Depth:	112`-0"
Height:	33`-0"

Architectural Style

Craftsman
Lodge
Mountain

Number of Rooms

Bedrooms:	6
Full Baths:	5
Half Baths:	2

Garage

Garage Size:	3
Garage Door Location:	Front
Garage Type:	Angled

Roof Pitches

Primary:	8:12
Secondary:	4:12

Wall Heights

Main:	10-0"
Upper:	9-0"
Lower:	9-0"

Foundation Type

Crawl Space

Roof Framing

Combination

Floor Load

Live (lbs):	40 PSF
Dead (lbs):	10 PSF

Roof Load

Live (lbs):	131 PSF
Dead (lbs):	15 PSF
Wind:	85 MPH

Design Features

- Suncadia Collection
- Bonus Space @ & Upper Floor
- Den/Office
- Rear Porch
- Great Room
- Laundry Room @ Main Floor
- Master Bedroom @ Main Floor Rear
- Craftsman House Plans
- Lodge House Plans
- Mountain House Plans
- Luxury Home Designs
- Wide Lot House Plans