



For Questions and Ordering

Call: 1-888-272-4100

E-mail: Info@ArchitectsNW.com

BRAEMOOR - M6369A3RS-0

Total Area: **6322 Sq. Ft.**
Garage Area: **814 Sq. Ft.**
Garage Size: **3**
Stories: **2**
Bedrooms : **5**
Full Baths : **5**
Half Baths : **1**
Width : **72'-0"**
Depth : **89'-2"**
Height : **29'-0"**
Foundation : **Crawl Space**



BRAEMOOR - M6369A3RS-0

MAIN FLOOR

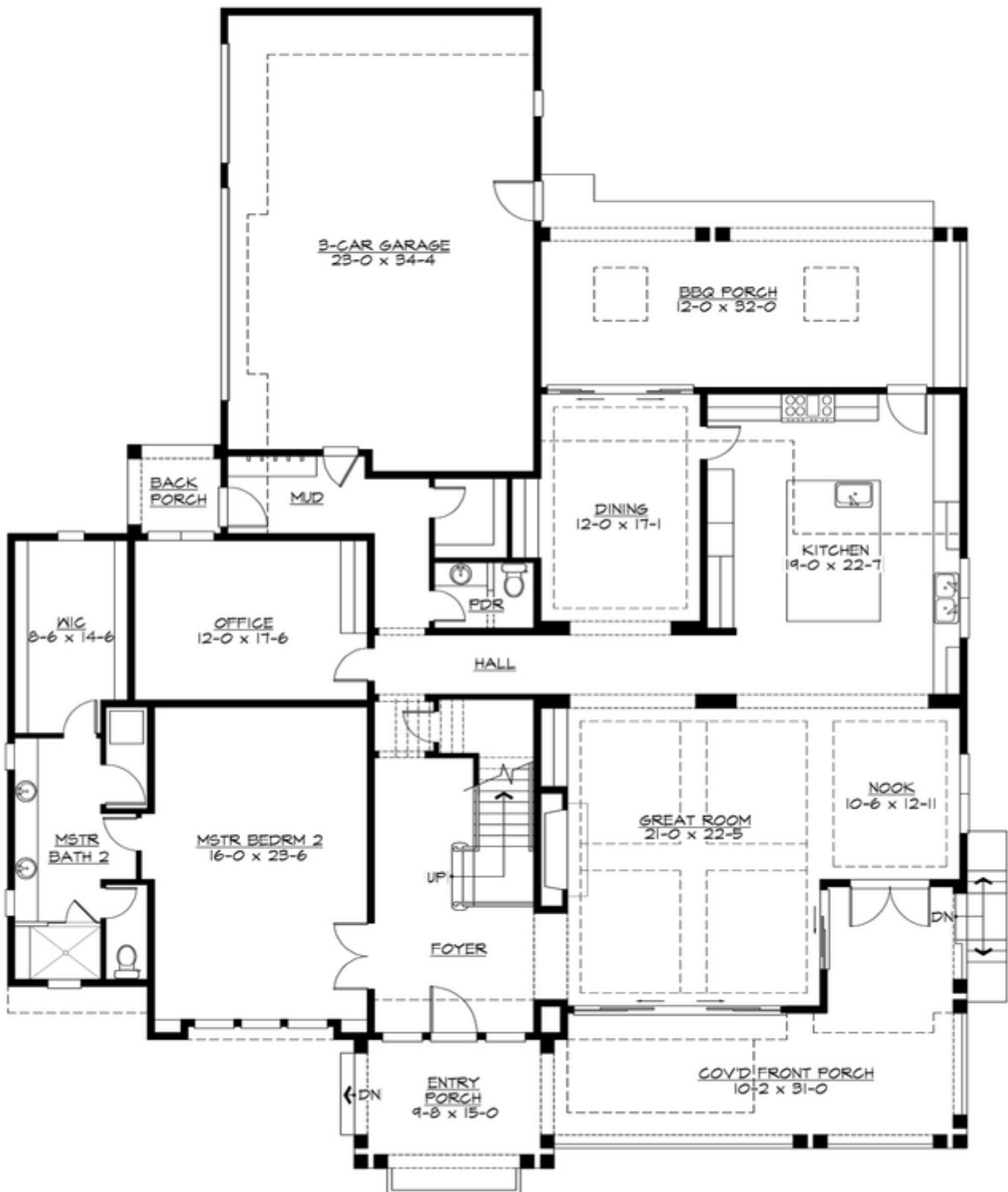

BRAEMOOR - M6369A3RS-0

UPPER FLOOR



BRAEMOOR - M6369A3RS-0

PLAN DETAILS

Area Summary

Total Area:	6322 Sq. Ft.
Main Floor:	2980 Sq. Ft.
Upper Floor:	3342 Sq. Ft.
Garage Floor:	814 Sq. Ft.

General Information

Stories:	2
Width:	72'-0"
Depth:	89'-2"
Height:	29'-0"

Architectural Style

Craftsman
Northwest
Shingle

Number of Rooms

Bedrooms:	5
Full Baths:	5
Half Baths:	1

Garage

Garage Size:	3
Garage Door Location:	Side

Roof Pitches

Primary:	4:12
Secondary:	3:12

Wall Heights

Main:	10'-0"
Upper:	9'-0"

Foundation Type

Crawl Space

Roof Framing

Trusses

Floor Load

Live (lbs):	40 PSF
Dead (lbs):	10 PSF

Roof Load

Live (lbs):	25 PSF
Dead (lbs):	15 PSF
Wind:	85 MPH

Design Features

- Bonus Space @ & Upper Floor
- Den/Office
- Front and Rear Porch
- Great Room
- Laundry Room @ & Upper Floor
- Master Bedroom @ Main Floor Front
- Craftsman House Plans
- Northwest Floor Plans
- Shingle House Plans
- View Lot (Front) Plans
- Wide Lot House Plans