



Your Family Architect



For Questions and Ordering

**Call: 1-888-272-4100**

E-mail: [Info@ArchitectsNW.com](mailto:Info@ArchitectsNW.com)

## **AVONDALE PARK HEIGHTS - M3105A3S-0DB**

Total Area: **4235 Sq. Ft.**

Garage Area: **735 Sq. Ft.**

Garage Size: **3**

Stories: **3**

Bedrooms : **5**

Full Baths : **3**

Half Baths : **1**

Width : **54`-0"**

Depth : **76`-0"**

Height : **26`-6"**

Foundation : **Basement**



# AVONDALE PARK HEIGHTS - M3105A3S-0DB

## MAIN FLOOR

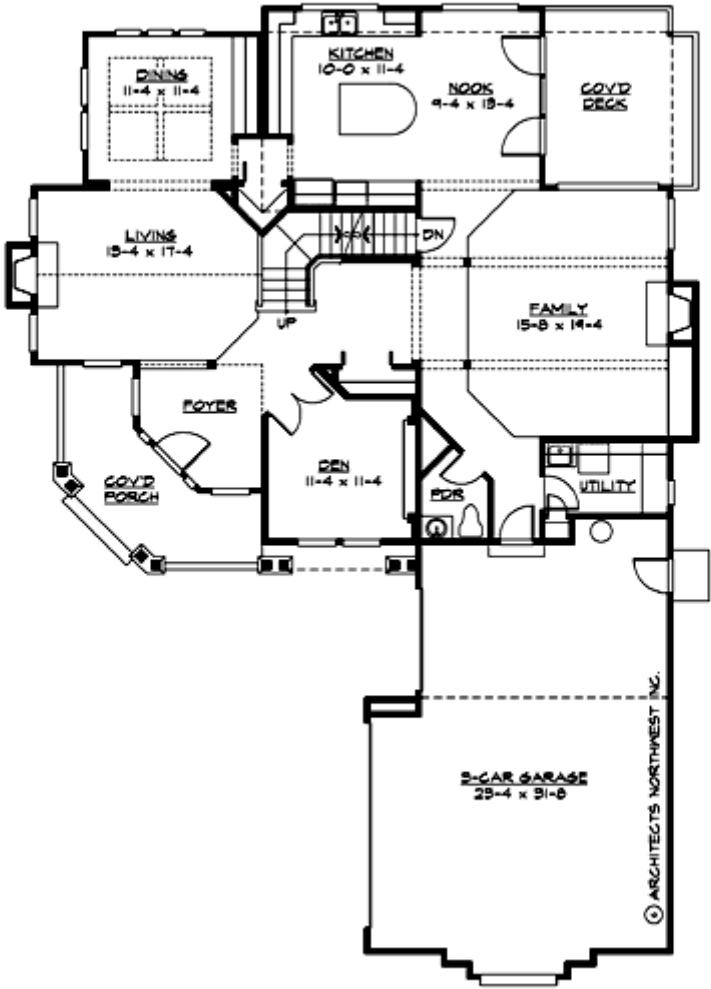

# AVONDALE PARK HEIGHTS - M3105A3S-0DB

## UPPER FLOOR

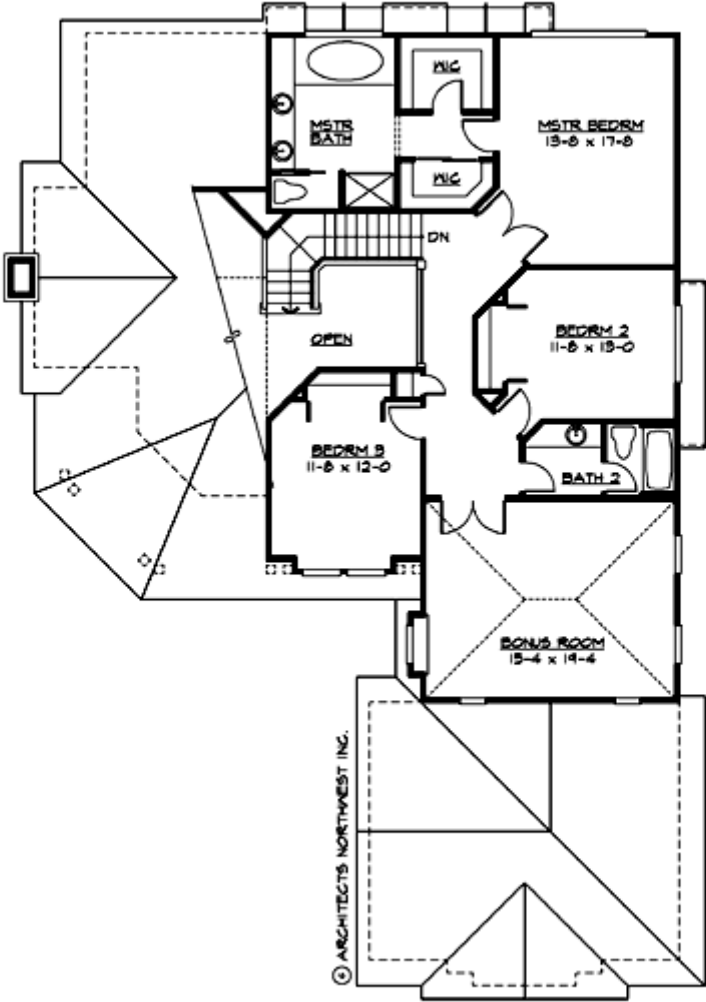

# AVONDALE PARK HEIGHTS - M3105A3S-0DB

## LOWER FLOOR

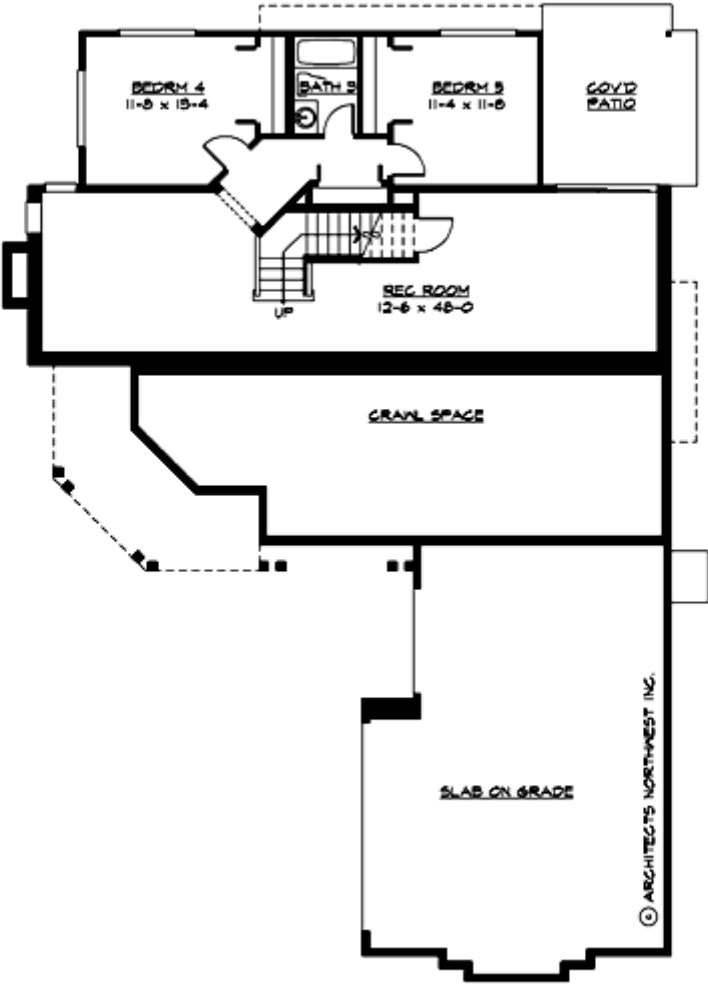

# AVONDALE PARK HEIGHTS - M3105A3S-0DB

## PLAN DETAILS

### Area Summary

Total Area:	<b>4235 Sq. Ft.</b>
Main Floor:	<b>1703 Sq. Ft.</b>
Upper Floor:	<b>1130 Sq. Ft.</b>
Lower Floor:	<b>1402 Sq. Ft.</b>
Garage Floor:	<b>735 Sq. Ft.</b>

### General Information

Stories:	<b>3</b>
Width:	<b>54`-0"</b>
Depth:	<b>76`-0"</b>
Height:	<b>26`-6"</b>

### Architectural Style

Craftsman  
Farmhouse  
Northwest

### Number of Rooms

Bedrooms:	<b>5</b>
Full Baths:	<b>3</b>
Half Baths:	<b>1</b>

### Garage

Garage Size:	<b>3</b>
Garage Door Location:	<b>Side</b>

### Roof Pitches

Primary:	<b>6:12</b>
----------	-------------

### Wall Heights

Main:	<b>9-0"</b>
Upper:	<b>8-0"</b>
Lower:	<b>9-0"</b>

### Foundation Type

Daylight Basement

### Roof Framing

Trusses

### Floor Load

Live (lbs):	<b>40 PSF</b>
Dead (lbs):	<b>10 PSF</b>

### Roof Load

Live (lbs):	<b>25 PSF</b>
Dead (lbs):	<b>15 PSF</b>
Wind:	<b>85 MPH</b>

### Design Features

- Bonus Space @ , Upper & Lower Floor
- Den/Office
- Front Porch
- Great Room
- Laundry Room @ Main Floor
- Master Bedroom @ Upper Floor Rear
- Craftsman House Plans
- Farmhouse Home Plans
- Northwest Floor Plans
- Narrow Lot House Plans